

Alin Machining Co., Inc. d/b/a

Power Plant Services

ISO 9001 Certified

"The Turnkey Solution"

Reverse Engineering

Reverse Engineering is an exact science and requires a large attention to details. Many times our customers do not have original drawings or designs to send to us to begin the process of manufacturing. The PPS Reverse Engineering department works in conjunction with our Quality Control department and has a complete process in place to assist in creating these drawing for our customers.

The PPS Reverse Engineering department process includes a check system through our Quality Control department to help ensure our customers are receiving the correct part for the correct use, made from the correct materials (process below).

To create a quality drawing for our customers, PPS utilized the 3 F's of Engineering: Form, Fit, & Function.

1. Form to construct a plan before the manufacturing process is considered.
2. Fit to determines specific requirements a part including tolerances, surface treatments, surface finish requirements, and material conditions.
3. Function to account for environmental conditions (temperature, pressure, erosion, corrosion factor, etc.), other parts used in conjunction (sliding fits, press fits, clearance fits, etc.), and modification or

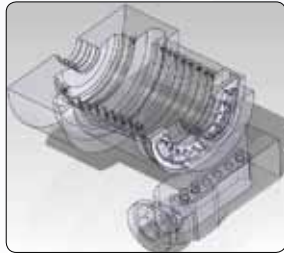

"upgrade" requests from customers or recommended changes from the OEM

Our equipment includes:

- Laser Scanner (3D model & inspection)
- Faro Arm Measurement of concentricity parallelism, angularity, plane location (axial measurements), etc.]
- CMM (Scan complex geometry for an accurate profile and transfer point cloud for making 3D models)
- Niton Analyzer (Determine Material)
- Hardness Tester (Check Hardness, HRC scale, HRB scale)
- Various hand tools: Traditional Caliper, Micrometer, Bore Gage, etc.)



24/7 emergency services available!

Questions on how we can help you? (708) 345-8600 or sales@ppsvcs.com

3131 W. Soffel Ave., Melrose Park, IL 60160

p (708) 345-8600 f (708) 345-9181 e sales@ppsvcs.com w www.ppsvcs.com

© 2013 All rights reserved. All photos and drawings are property of Alin Machining Co., Inc., Power Plant Services, Power Plant Repair Services, and Power Plant Field Services and should not be copied or reused without written permission. MKL-132, Rev-0, 0513